

## Pressure sensor



Current type (P224A)



Voltage type (P321)

## Product Description

Used to check the pressure value of refrigerating system condition

## Features

- EMC/EMI adapts frequency conversion environment application;
- Instantaneous protective voltage: DC16V;
- Compatible with multiple refrigerants, wide application range;
- Power supply reverse connection protection;
- Anti-condensation design for current type pressure sensor

## Technical Parameters

Model	P224A	P321
Working Voltage	24VDC (15~32VDC)	5±0.25VDC
Output Signal	4~20mA	0.5~4.5VDC
Media Temperature		-40°C~125°C
Service Life		more than 10,000,000 times
Long-term stability		±0.5%/FS/year
Protection level		IP66

### Model selection

Model	Pressure range	Safety overload	Breaking pressure	Working voltage	Output signal	Comprehensive Precision
HS-F321-30-10barG	0-10bar	30bar	160bar	5VDC	0.5~4.5VDC	±2.5%FS
HS-F321-30-20barG	0-20bar	60bar	160bar	5VDC	0.5~4.5VDC	±2.5%FS
HS-F321-30-30barG	0-30bar	90bar	250bar	5VDC	0.5~4.5VDC	±2.5%FS
HS-F321-30-45barG	0-45bar	90bar	250bar	5VDC	0.5~4.5VDC	±2.5%FS
HS-F321-30(-1-12)barG	-1~12bar	36bar	160bar	5VDC	0.5~4.5VDC	±2.5%FS
HS-F224A-30-11barG	-1~11bar	60bar	160bar	24VDC(12~23VDC)	4~20mA	±1%FS
HS-F224A-30-18barG	0-18bar	60bar	160bar	24VDC(12~23VDC)	4~20mA	±1%FS
HS-F224A-30-30barG	0-30bar	90bar	250bar	24VDC(12~23VDC)	4~20mA	±1%FS
HS-F224A-30-50barG	0-50bar	90bar	250bar	24VDC(12~23VDC)	4~20mA	±1%FS

### Overall dimension

#### Current type

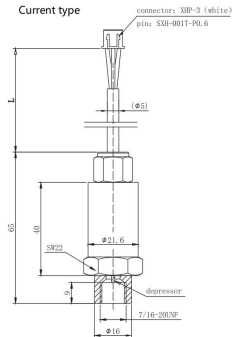

#### Voltage type

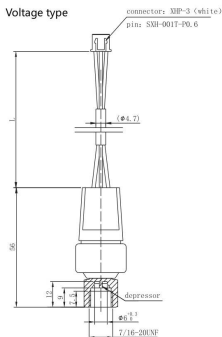

### Wiring drawing

#### Current type

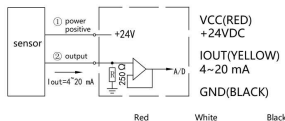

#### Voltage type

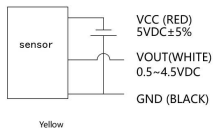

## Temperature sensor



5K3470

### Product Description

Used to check the temperature value of refrigerating system condition

### Features

- Small size, light weight, good protective performance
- Small temperature deviation, high precision

### Model

NTC, R25II = 5K, B25/50II = 3470K