

Model KM Diaphragm Hand Valve



Product Description

- Model KM hand valve is a manually operated diaphragm stop valve for one-way flow control.
- Model KM hand valve is mounted on the liquid, air suction and hot air piping in the refrigeration, cold storage and air conditioner.
- Two types of connection are available for Model KM hand valve, that is,

threaded connection (SAE) with threading size 1/4 SAE to 3/4 SAE and welded connection both ODF, structure hand valves have connection size 1/4" to 7/8" .

- All Model KM hand valves are equipped with mounting hole for the installation on the instrument panel.

Features

- There are 2 pieces of stainless steel diaphragm to prevent the hand valve from leakage during the whole service life of the hand valve.
- The elastic sealing is used on the valve port so that the hand valve could be shut off by small torque.

- The special valve bonnet design is used to prevent the hand valve from water or dust penetration.
- The hand valve is easy to be operated for full open or half open just by turning the valve stem for one and half turn.

Technical Parameters

Applicable Refrigerant:	HCFC, HFC
Applicable Medium Temperature:	-25°C~+100°C
MAX Working Pressure	3.0MPa
Scope of Operating Pressure	-0.1MPa~2.1MPa
Maximum Hydrostatic Test Pressure	4.5MPa

Structure

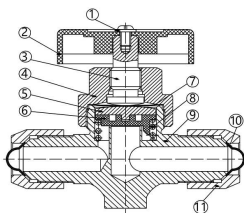

- screw
- hand wheel
- valve stem
- valve bonnet
- copper sheet
- valve element
- diaphragm
- spring
- valve body
- nut
- pinning nut

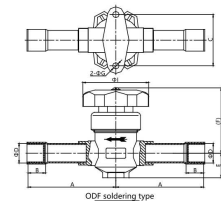

Model Selection

Model	Flare	Welded(with copper tube)	Kv(m ³ /h)
KM-1/4	1/4 SAE	1/4 ODF	0.25
KM-3/8	3/8 SAE	3/8 ODF	0.30
KM-1/2	1/2 SAE	1/2 ODF	1.30
KM-5/8	5/8 SAE	5/8 ODF	1.80
KM-3/4	3/4 SAE	3/4 ODF	3.65
KM-7/8	—	7/8 ODF	3.65

Overall Dimension

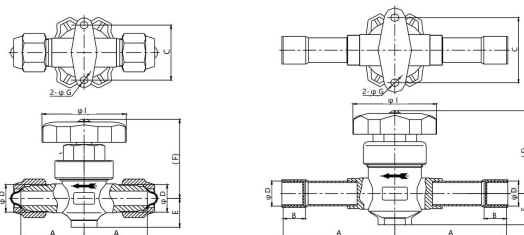

Model	Overall Dimension												
	A	B	C	φD	E	(F)	φG	φH	S	N	Thread M		
1/4 SAE	28.5	—	—	—	—	—	—	—	—	S17	7/16-20UNF		
1/4 ODF	S1	7	36	6.5	14	(53)	φ4.5	—	S18	—	—		
3/8 SAE	31	—	—	—	—	—	—	—	—	S22	5/8-18UNF		
3/8 ODF	59	8	—	9.7	—	—	—	—	—	—	—		
1/2 SAE	39	—	—	—	—	—	—	—	—	S24	3/4-16UNF		
1/2 ODF	66	10	—	12.8	—	—	—	—	S22	—	—		
5/8 SAE	39	—	38	—	19	(57)	φ5	—	—	S27	7/8-14UNF		
5/8 ODF	74	14	—	16.1	—	—	—	—	—	—	—		
3/4 SAE	50	—	—	—	—	—	—	—	—	S32	1-1/16-14UNS		
3/4 ODF	80	16	50	19.1	24	(64)	φ6	φ60	S27	—	—		
7/8 ODF	80	17	—	22.3	—	—	—	—	φ71	—	—		